

Improving Network Management through alternative traffic management techniques.

Warwickshire County Council

Solihull MBC

Presentation Overview

- - Role of Network Management.
- - Network knowledge.

Role of Network Management

- Balancing the need for many different people and organisations who want access to roads, footways, cycle-ways ...

Network
management

Asset
management

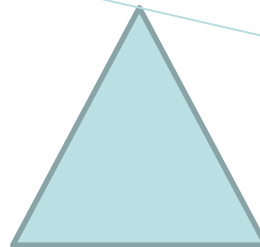

Role of Network Management

Road Users
Events
Public Transport
Emergency Services

Utilities
HS2
Highways
Parish Councils
Developers
Skips & Scaffolding

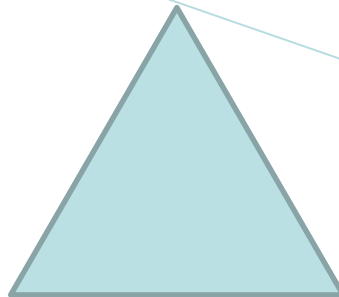

NRSA (1991)

- **New Roads and Street Works Act (1991)**
- Section 59 places a duty on highway authorities to co-ordinate works on the highway.
- Equally important is the parallel duty on undertakers (utility companies) to co-operate in this process under Section 60.

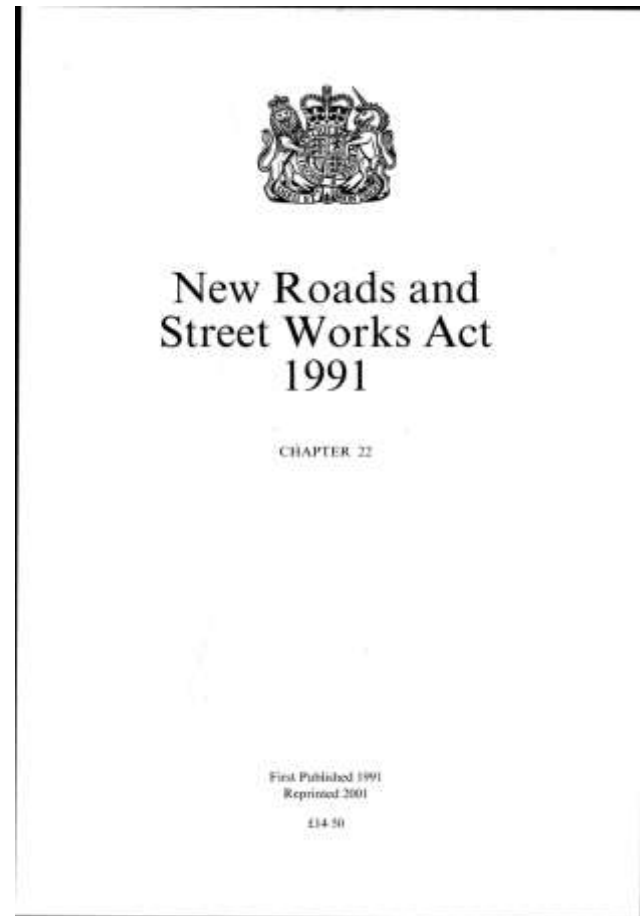

Case Study

- Network Rail, Fosseway Warwickshire
- Brickwork and Parapet renewals, original request for 25 week closure.
- Agreed 10 week one way order.
- Local employer Jaguar, Landrover with 7500 employees on the one site at Gaydon.

Fosseway Harbury

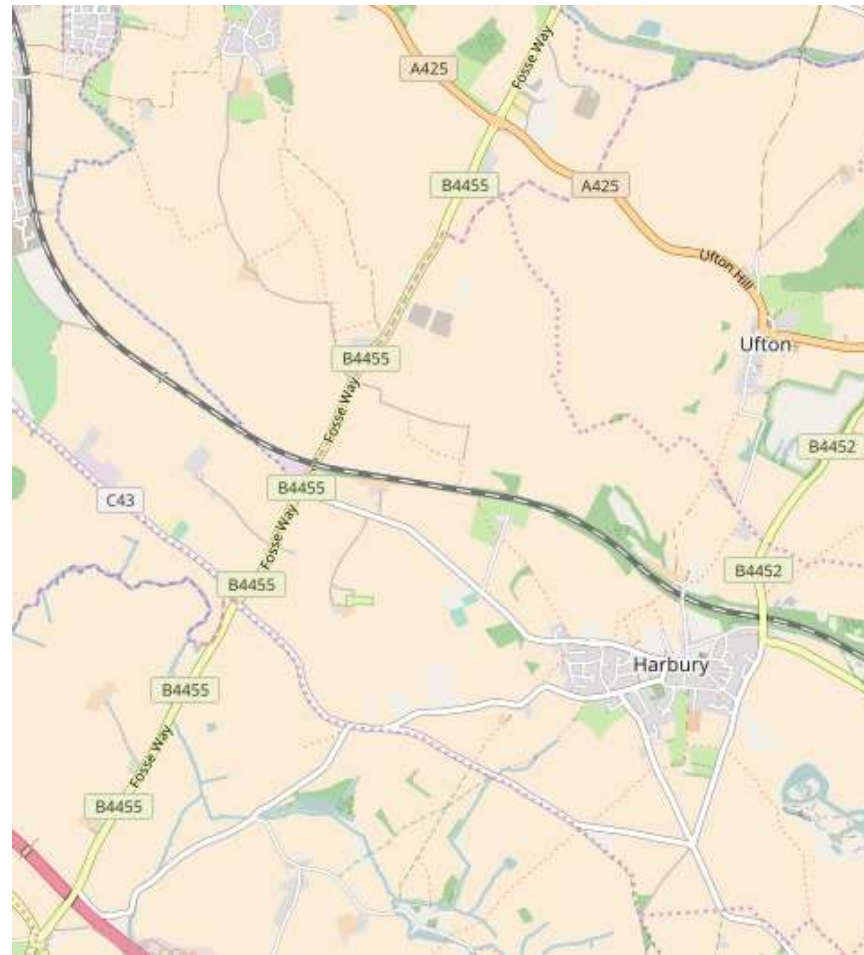

Network Rail, Fosseway Harbury



Network Rail, Fosseway Harbury



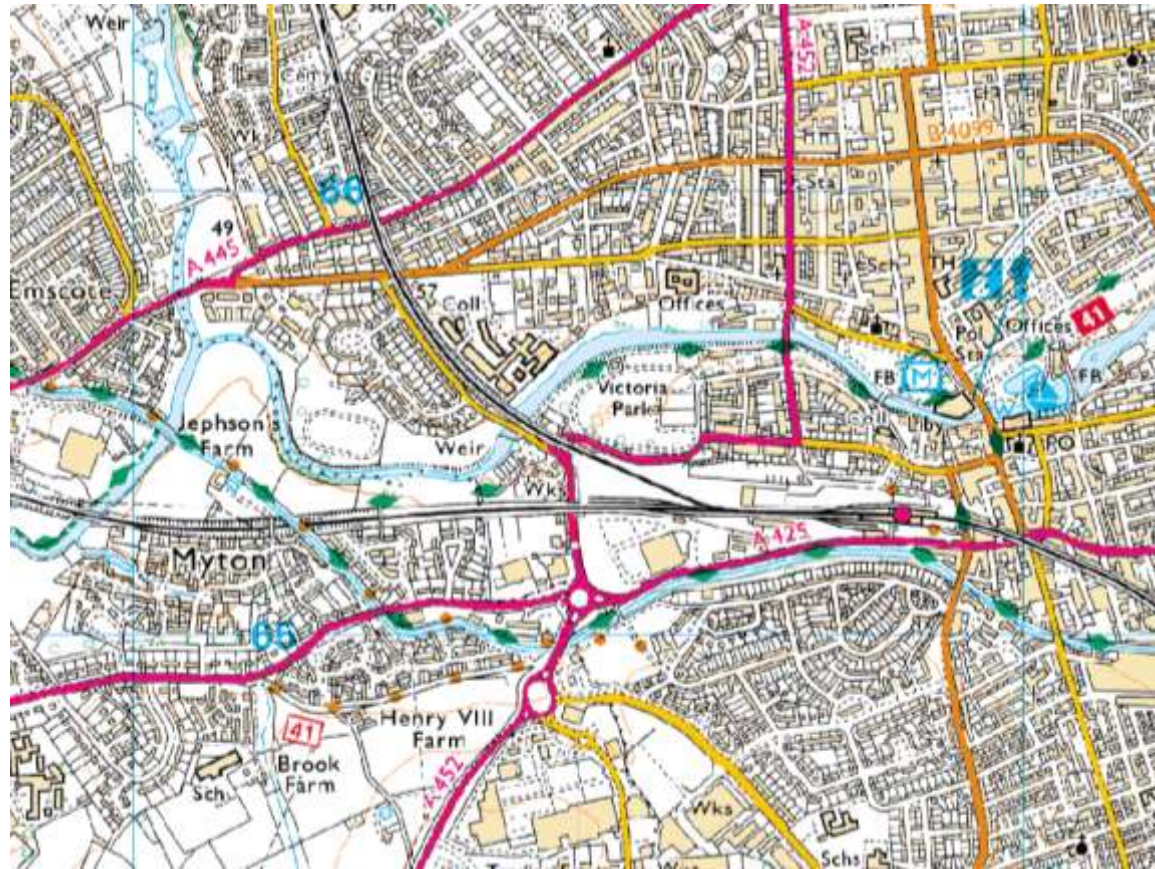

Princess Drive, wider context

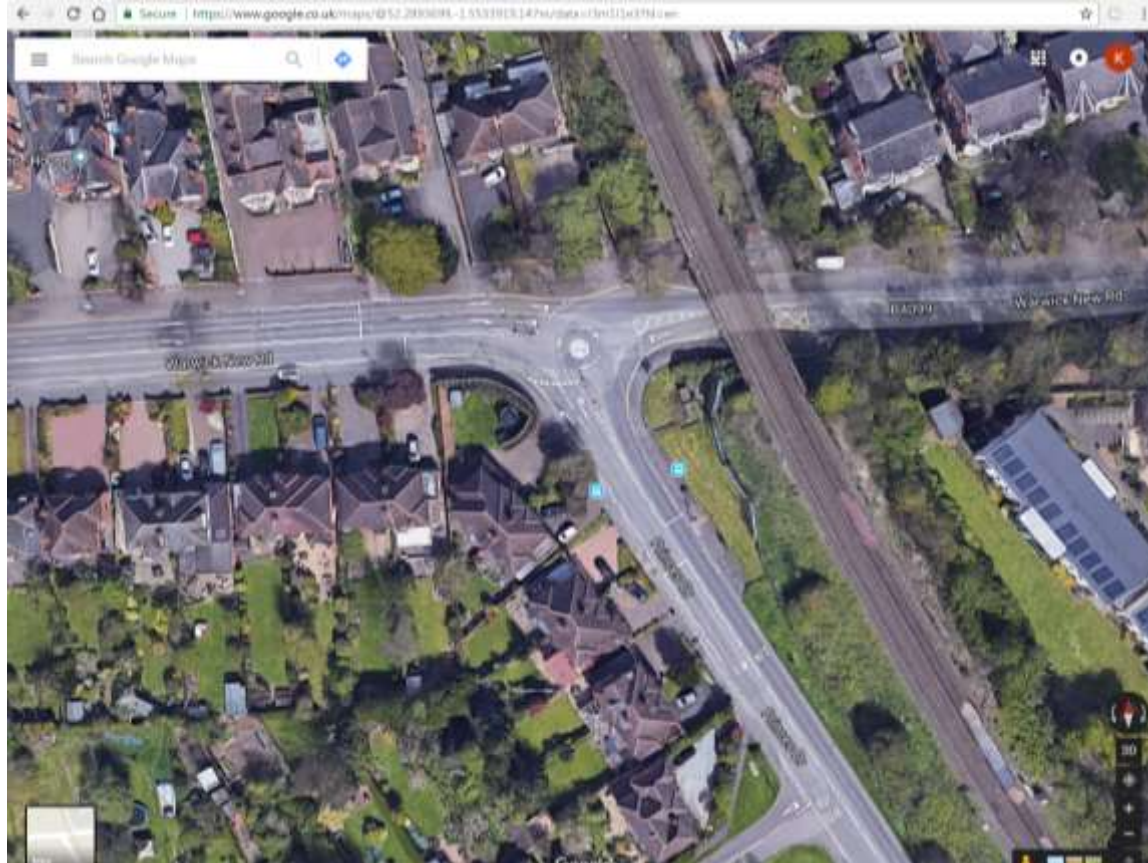

Princes Drive Leamington Spa

Emergency Gas escape.



Looking east towards Leamington



Looking west towards Warwick



Looking south.



Restricted movements around the Mini Roundabout.



Excavation took out a lane and restricted the width under the bridge.



Pedestrian crossing switched off.

Lawford Road Rugby

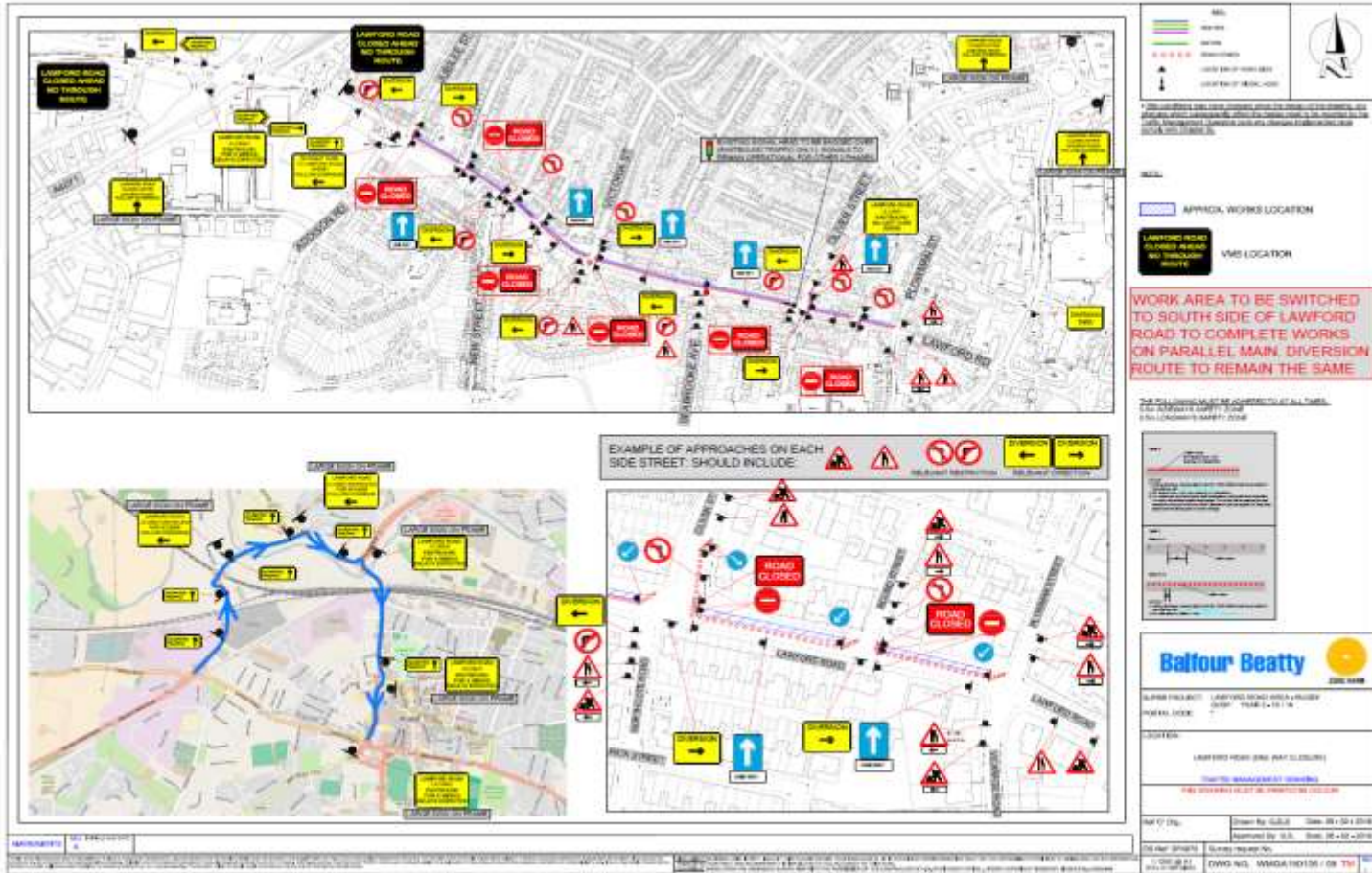

Lawford Road, Rugby.



Questions

streetworks@warwickshire.gov.uk